

Submersible pump with impeller and cutting device for pumping wastewater and slurries containing fiber. The pump is equipped with 10 m cable, float switch and built-in thermal motor protection.



Construction characteristic

- pump body of cast iron GG20
- steel impeller ZG 35
- cutting wheel and grinder of ZG40Cr
- Stainless steel shaft 2 Cr13
- double mechanical seal (C/Ceramics, SiC/SiC)

Motor

- Stainless steel shaft
- dry-run motor
- degree of protection IP 68
- insulation class B
- single phase version with built-in condenser
- speed 2800 rpm
- single phase version with float switch
- max. switching time 30/hour
- power cable H07RN-F 3x1 mm

Usage

- type of liquid: sludge and wastewater with solid particles and fiber
- max. pumped liquid temperature 40°C
- pump head height 16 m

Aplikace

- use in industry, in the home
- pumping of waste water and sediments with textile fibers
- liquid chemically compatible with pump material

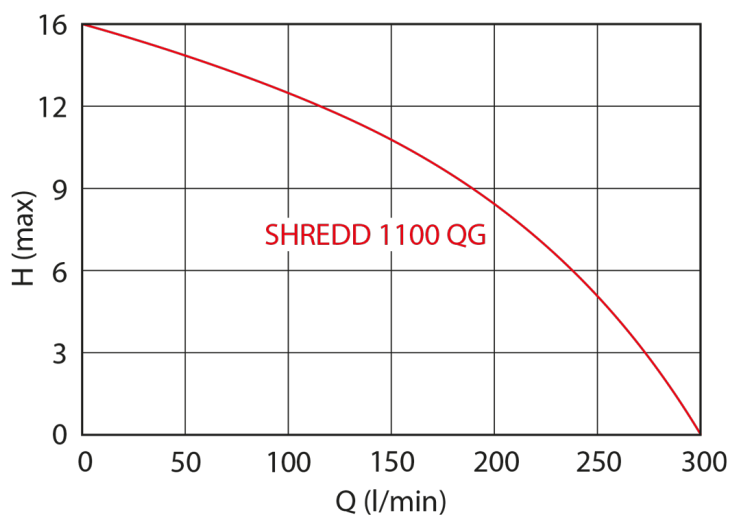

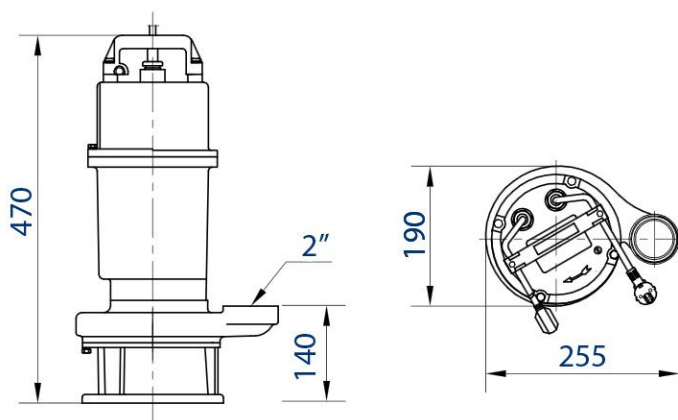

| | |
|--------------------------|----------------|
| Type: | SHREDD 1100 QG |
| Power input: | 1100 W |
| Q max: | 18 000 l/h |
| Head hight: | 16 m |
| Voltage: | 230 V |
| Weight: | 33 kg |
| DNM dimensions: | 2" - 2 1/4" |
| Connection: | 2" - 2 1/4" |
| Max. temperature: | 40 °C |

